

VILLAGE of GERMANTOWN HILLS WOODFORD COUNTY ILLINOIS

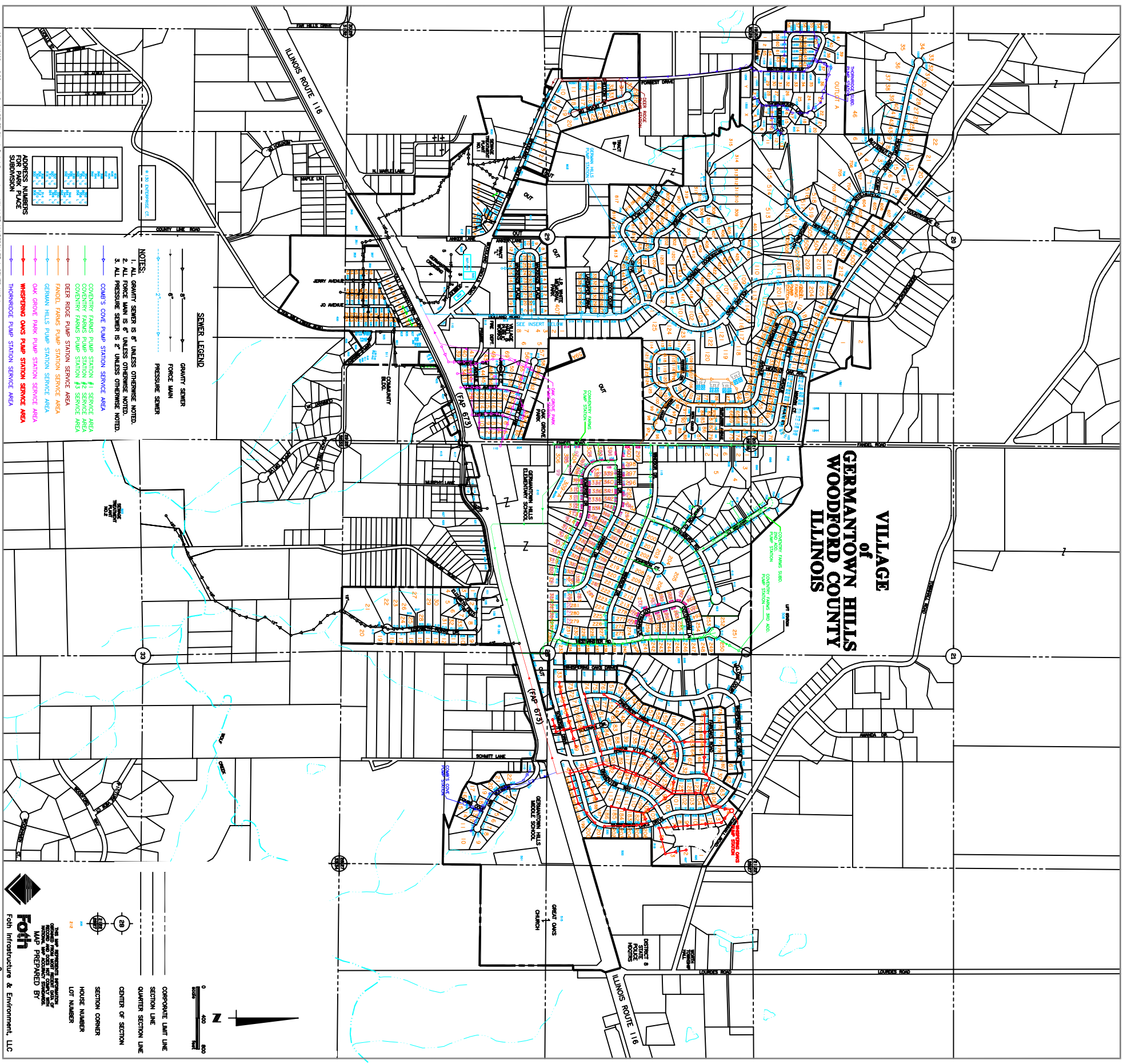

SEWER LEGEND

- GRANITY SEWER
- FORCE MAIN
- PRESSURE SEWER

NOTES:

1. ALL GRANITY SEWER IS 6" UNLESS OTHERWISE NOTED.
2. ALL FORCE MAIN IS 6" UNLESS OTHERWISE NOTED.
3. ALL PRESSURE SEWER IS 2" UNLESS OTHERWISE NOTED.

- COAK'S COVE PUMP STATION SERVICE AREA
- COVENTRY PARK PUMP STATION #1 SERVICE AREA
- COVENTRY PARK PUMP STATION #2 SERVICE AREA
- COVENTRY PARK PUMP STATION #3 SERVICE AREA
- BEER RIDGE PUMP STATION SERVICE AREA
- FRANZEL PUMP STATION SERVICE AREA
- GERMAN HILLS PUMP STATION SERVICE AREA
- OAK GROVE PARK PUMP STATION SERVICE AREA
- WILSON OAKS PUMP STATION SERVICE AREA
- HANDSHOE PUMP STATION SERVICE AREA

0 400 800
SCALE

COMPONENT LIMIT LINE
SECTION LINE
QUARTER SECTION LINE
CENTER OF SECTION
SECTION CORNER
HOUSE NUMBER
LOT NUMBER

Foth
Foth Infrastructure & Environment, LLC

THE MAP REPRESENTS AN APPROXIMATE SERVICE AREA AND IS NOT A CONTRACT. THE MAP WAS PREPARED BY FOTH INFRASTRUCTURE & ENVIRONMENT, LLC.